

# WHELEN<sup>®</sup>

ENGINEERING COMPANY INC.

51 Winthrop Road  
Chester, Connecticut 06412-0684  
Phone: (860) 526-9504  
Internet: [www.whelen.com](http://www.whelen.com)  
Sales e-mail: [lowsales@whelen.com](mailto:lowsales@whelen.com)  
Customer Service e-mail: [iowserv@whelen.com](mailto:iowserv@whelen.com)

Model WS60T Speaker Assembly  
P/N: 01-1461236-00

## General-

Whelen Model WS60T is a 60 watt speaker assembly intended for use in indoor personnel warning applications, where high sound level output is required.

The speaker flare is made from fiberglass, with a spun aluminum re-entrant section. A speaker driver, with wire leads, is assembled to the speaker. A heavy-duty, painted steel mounting bracket allows the installer to position the speaker in a number of different ways.

An internal impedance matching transformer allows the user to select reduced power levels.

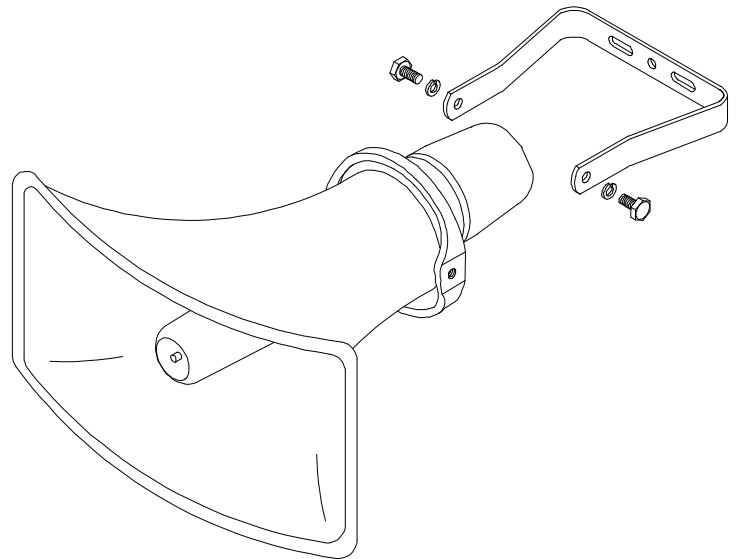

## Installation-

Determine the location of the speaker. Mount to a rigid structure, using the supplied mounting bracket. The bracket dimensions are shown in the detail drawing. Position the speaker as required. Do not position the speaker pointing upward, if there is a possibility of filling with water.

Speaker connections are made by removing the plastic cover and connecting one audio wire to the “-” terminal and the other audio to the desired tap terminal. The “+” terminal is full power.

Mounting Bracket Detail

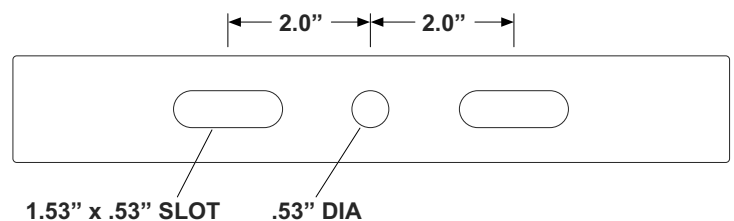

Mass Notification

**Dimensions**

Height: 12" (30.4 cm)  
Width: 22" (55.8 cm)  
Depth: 23" (58.3 cm)  
Weight: 21 lbs. (9.5 kg)

**Performance**

SPL:	60W	123 dbA (at 4 ft., 500 Hz)
	40W	121 dbA
	20W	118 dbA
	10W	115 dbA
	5W	112 dbA
	2.5W	109 dbA

**Finish**

Speaker: Black

Dispersion: °120 x 60°

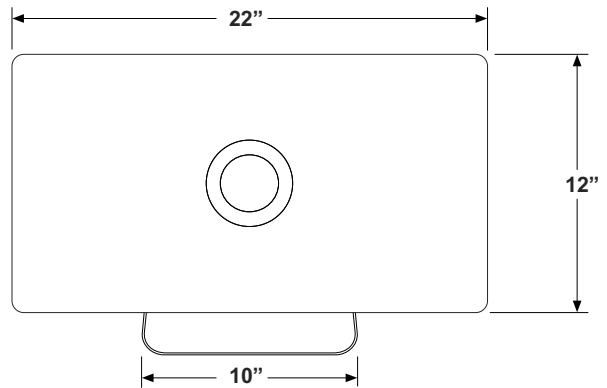
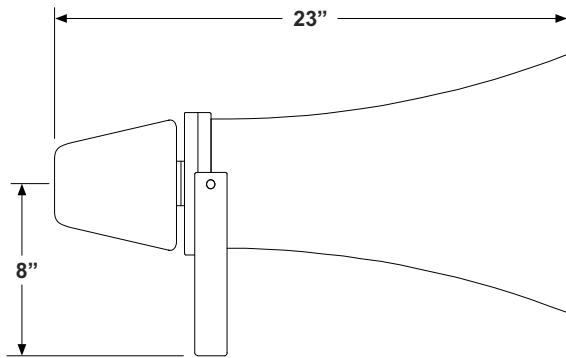

**DIMENSIONS**

**Notes:**

1. Not for use in classified areas.
2. SPL (Sound Pressure Level) readings are +/- 2 dbA.
3. Performance measured with Whelen Amplifier, 01-0285564-00C